



# Light Power Board w/ connector Kit [002-1689-00]

## Components:

PC Board..... 1  
Install Instructions... 1

## Special Tools:

none



### Warning

Always disconnect power before removing covers.  
Failure to do so may result in personal injury.



### Equipment Alert

Improperly connecting leads may  
permanently damage PC Board.

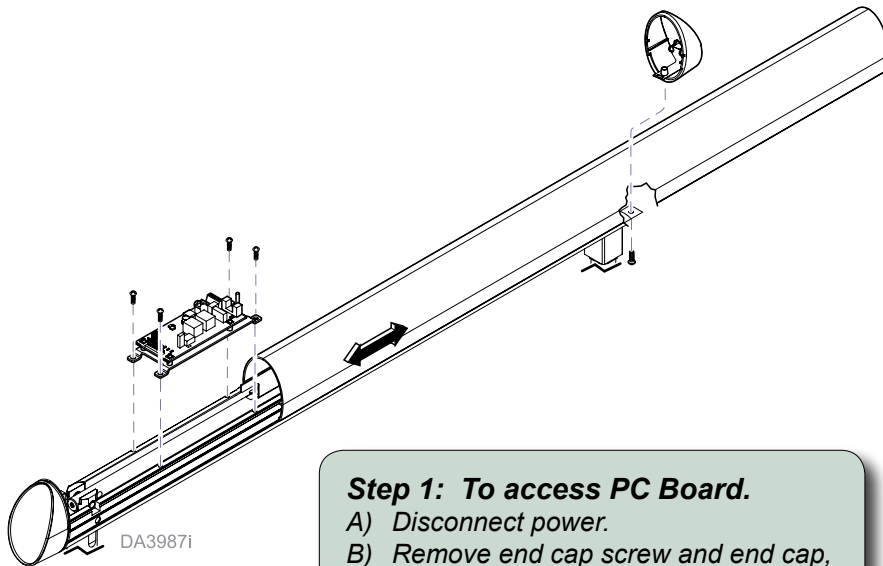

### Step 1: To access PC Board.

- Disconnect power.
- Remove end cap screw and end cap, then slide cover back.
- Disconnect wire connections and remove PC Board.

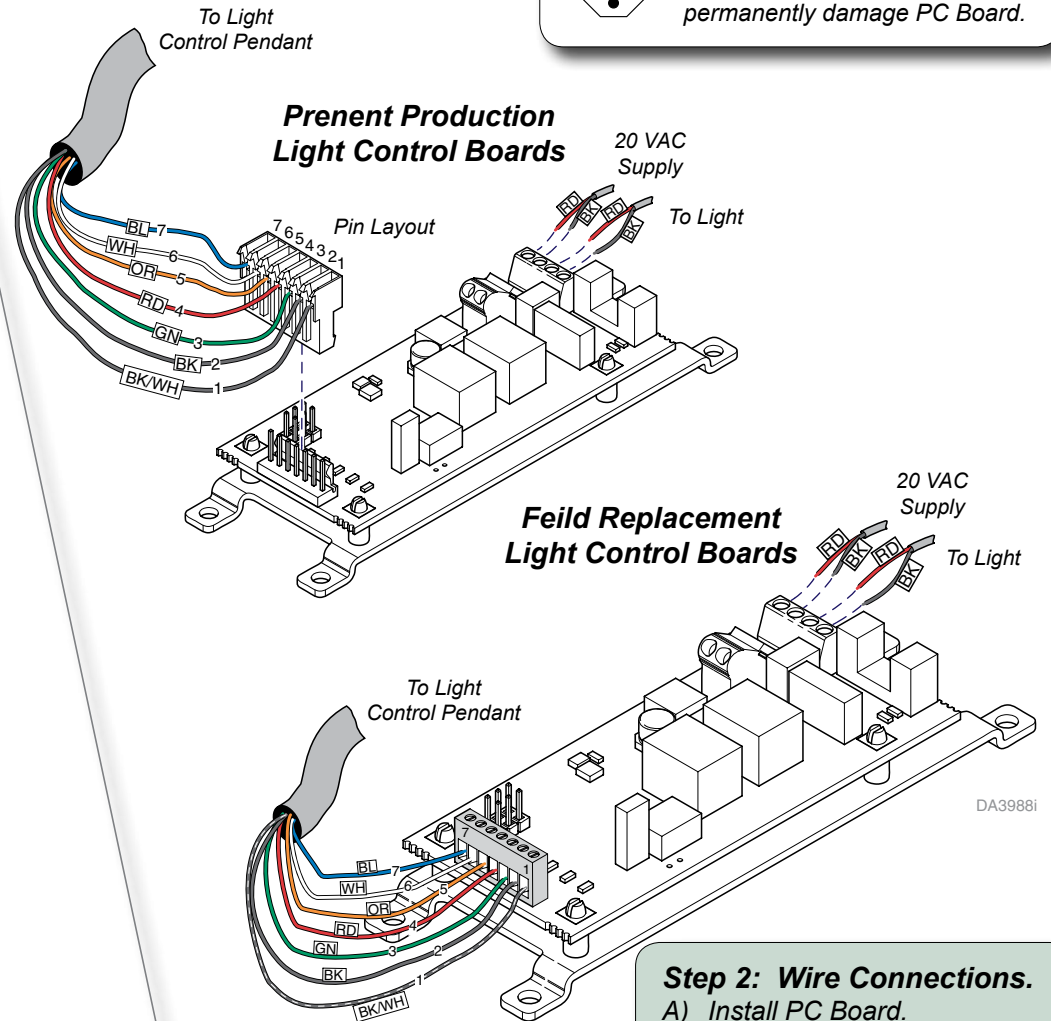

### Step 2: Wire Connections.

- Install PC Board.
- Connect wiring as shown.

### Note

This adjustment allows setting the desired height (when light arm is lowered) of light arm at which AUTO ON mode is activated (light automatically turns on).  
On some units both end caps may need to be removed.



### WARNING

Use caution when operating equipment with covers removed.

### Step 3: To adjust AUTO ON mode.

- A) Position light arm at desired height for AUTO ON mode to activate and hold in this position.
- B) Loosen two screws, slide trigger all the way out, then slowly slide trigger in until lighthouse turns on at set point line.
- C) Tighten two screws to secure trigger.

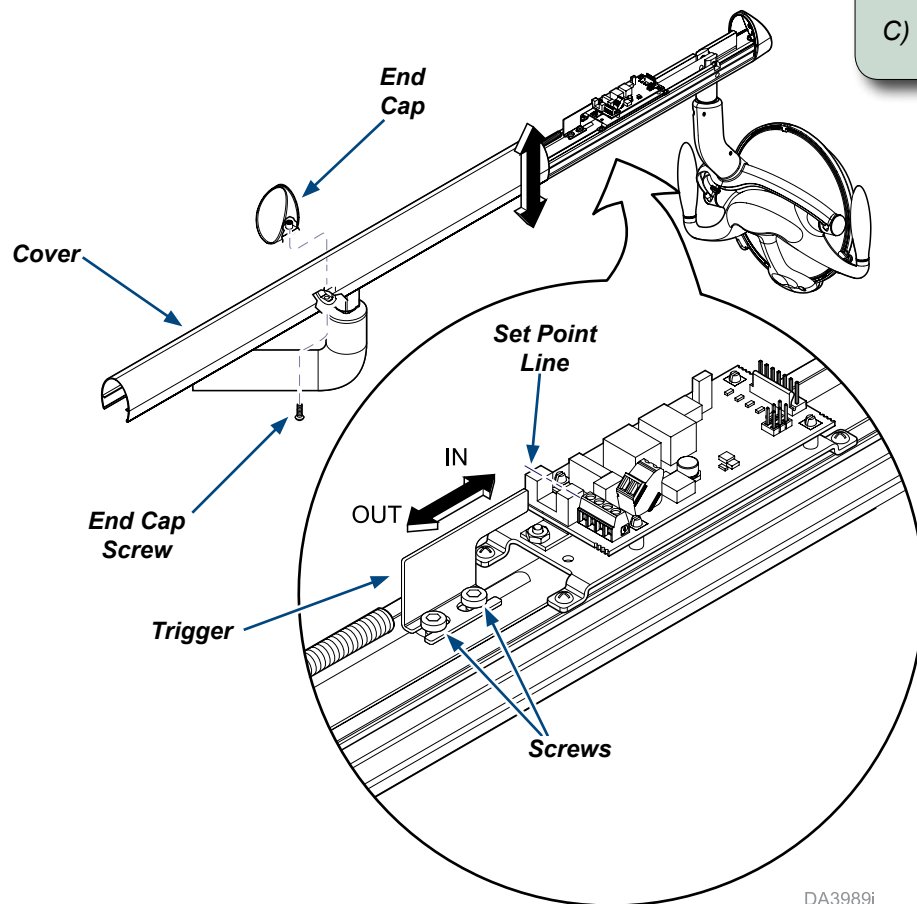

### Step 4: To complete installation.

- A) Slide cover into place.
- B) Secure with end cap and screw.

DA3989i

